

**COUPLINGS, MULTICOUPLINGS & MOULD COOLING PRODUCTS**

KUPPLUNGEN, MULTIKUPPLUNGEN & KÜHLUNGSELEMENTE FÜR WERKZEUGE

**SERIE 101**



**QUICK COUPLINGS FOR MOULD AND GENERAL INDUSTRY**

**SCHNELLVERSCHLUSSKUPPLUNGEN FÜR FORMWERKZEUGE UND ALLG. INDUSTRIE**

For plastic injection moulding, heat transfer fluids and all industrial applications

Für Kühlung und Temperaturregelung von Kunststoffformen und Maschinen

**Technical Specification:**

Single or double shut-off  
101.16 plug body manufactured from stainless steel and hardened  
101.20 - 101.25 - 101.38 plug body manufactured from stainless steel  
The O-ring for all 101 serie couplers are Fluorocarbon FPM (V).

**Using Area :**

- On cooling system of plastic zamak and aluminium injection molds
- On mould temperature control lines of thermoplastic injection moulding
- On water cooling circuit of welding machines
- On cleaning and washing systems of machines
- On hot oil lines connections
- All industries
- On steam lines

**Nutzungsbereich:**

- An Kühlsystemen für Kunststoff-, Zamak-, Messing und Aluminium-, Kokillenformen
- An Reinigungs- und Waschsystemen von Maschinen
- An Heissöleleitungsanschlüssen
- Alle Industriezweige
- An Dampfleitungen

**Technische Eigenschaften:**

- Ein-oder beidseitiges Ventil
- 101.16 Nippel aus gehärtetem Edelstahl
- 101.20 - 102.25 - 101.38 Kupplungskörper aus Edelstahl
- O-Ringe der Serie 101 sind FPM (V)

**TST 101**





SERIE 101 ■

COUPLINGS, MULTICOUPLINGS & MOULD COOLING PRODUCTS

KUPPLUNGEN, MULTIKUPPLUNGEN & KÜHLUNGSELEMENTE FÜR WERKZEUGE



QUICK COUPLINGS FOR MOULD AND GENERAL INDUSTRY

● **SCHNELLVERSCHLUSSKUPPLUNGEN FÜR FORMWERKZEUGE UND ALLG. INDUSTRIE** ●

● TST 101.06

**Material - Material**

- Coupler Body - Kupplungsgrundkörper : Brass - Messing
- Sleeve - Hülse : Stainless Steel - Edelstahl (AISI 420)
- Valve - Ventil : Brass - Messing
- Springs - Federn : Stainless Steel - Edelstahl
- Balls - Kugeln : Stainless Steel - Edelstahl
- Seals - Dichtungen : Fluorocarbon FPM (V)
- Plug - Nippel : Brass Nickel Plated - Messing Vernickelt



Ø Nominal - Nennweite (mm)	6	
Working Pressure - Betriebsdruck (bar)	16	
Cross section - Querschnitt (mm <sup>2</sup> )	28,3	
Number of the Balls - Anzahl der Kugeln	6	
Working Temperature - Betriebstemperatur	V - Viton (FPM)	-10°C +200°C
	E - Ethylene Prop. (EPDM)	-20°C +150°C
	Ni - Nitrile (NBR)	-15°C +100°C
Flowing - Ausführung	Single Shut-Off	—○—+←
	Double Shut-Off	—○—+←○—
	Full Flow	—→+←

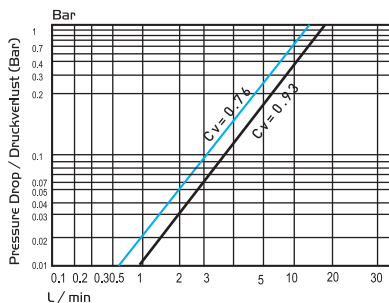

- Double Shut-off / Beidseitig absperrend
- Single Shut-off / Einseitig absperrend

Flow direction - Flußrichtung : Plug to socket - von Stecker zu Kupplung  
Oil Viscosity at - Öl Viskosität 40° : C:13,4 cst

● TST 101.09

**Material - Material**

- Coupler Body - Kupplungsgrundkörper : Brass - Messing
- Sleeve - Hülse : Stainless Steel - Edelstahl (AISI 420)
- Valve - Ventil : Brass - Messing
- Springs - Federn : Stainless Steel - Edelstahl
- Balls - Kugeln : Stainless Steel - Edelstahl
- Seals - Dichtungen : Fluorocarbon FPM (V)
- Plug Body- Nippel : Brass Nickel Plated - Messing Vernickelt



Ø Nominal - Nennweite (mm)	9	
Working Pressure - Betriebsdruck (bar)	16	
Cross section - Querschnitt (mm <sup>2</sup> )	63,9	
Number of the Balls - Anzahl der Kugeln	6	
Working Temperature - Betriebstemperatur	V - Viton (FPM)	-10°C +200°C
	E - Ethylene Prop. (EPDM)	-20°C +150°C
	Ni - Nitrile (NBR)	-15°C +100°C
Flowing - Ausführung	Single Shut-Off	—○—+←
	Double Shut-Off	—○—+←○—
	Full Flow	—→+←

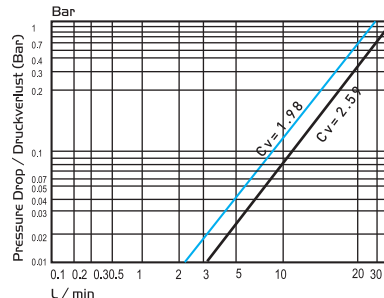

- Double Shut-off / Beidseitig absperrend
- Single Shut-off / Einseitig absperrend

Flow direction - Flußrichtung : Plug to socket - von Stecker zu Kupplung  
Oil Viscosity at - Öl Viskosität 40° : C:13,4 cst

COUPLINGS, MULTICOUPLINGS & MOULD COOLING PRODUCTS

KUPPLUNGEN, MULTIKUPPLUNGEN & KÜHLUNGSELEMENTE FÜR WERKZEUGE

■ SERIE 101



QUICK COUPLINGS FOR MOULD AND GENERAL INDUSTRY

- SCHNELLVERSCHLUSSKUPPLUNGEN FÜR FORMWERKZEUGE UND ALLG. INDUSTRIE ●

● TST 101.12

Material - Material

- Coupler Body - Kupplungsgrundkörper : Brass - Messing
- Sleeve - Hülse : Stainless Steel - Edelstahl (AISI 420)
- Valve - Ventil : Brass - Messing
- Springs - Federn : Stainless Steel - Edelstahl
- Balls - Kugeln : Stainless Steel - Edelstahl
- Seals - Dichtungen : Fluorocarbon FPM (V)
- Plug - Nippel : Brass Nickel Plated - Messing Vernickelt



Ø Nominal - Nennweite (mm)	12	
Working Pressure - Betriebsdruck (bar)	16	
Cross section - Querschnitt (mm <sup>2</sup> )	113	
Number of the Balls - Anzahl der Kugeln	6	
Working Temperature - Betriebstemperatur	V - Viton (FPM)	-10°C +200°C
	E - Ethylene Prop. (EPDM)	-20°C +150°C
	Ni - Nitrile (NBR)	-15°C +100°C
Flowing - Ausführung	Single Shut-Off	→+←
	Double Shut-Off	→+←
	Full Flow	→+←

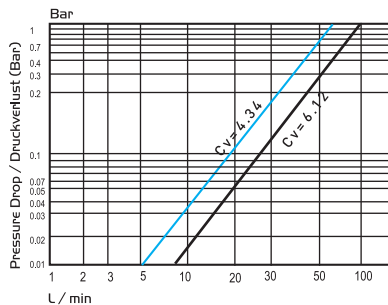

- Double Shut-off / Beidseitig absperrend
- Single Shut-off / Einseitig absperrend

Flow direction - Flußrichtung : Plug to socket - von Stecker zu Kupplung  
Oil Viscosity at - Öl Viskosität 40° : C:13.4 cst

● TST 101.16

Material - Material

- Coupler Body - Kupplungsgrundkörper : Brass - Messing
- Sleeve - Hülse : Stainless Steel - Edelstahl (AISI 420)
- Valve - Ventil : Brass - Messing
- Springs - Federn : Stainless Steel - Edelstahl
- Balls - Kugeln : Stainless Steel - Edelstahl
- Seals - Dichtungen : Fluorocarbon FPM (V)
- Plug Body- Nippel : Stainless Steel - Edelstahl (AISI 420)



Ø Nominal - Nennweite (mm)	16	
Working Pressure - Betriebsdruck (bar)	16	
Cross section - Querschnitt (mm <sup>2</sup> )	201	
Number of the Balls - Anzahl der Kugeln	12	
Working Temperature - Betriebstemperatur	V - Viton (FPM)	-10°C +200°C
	E - Ethylene Prop. (EPDM)	-20°C +150°C
	Ni - Nitrile (NBR)	-15°C +100°C
Flowing - Ausführung	Single Shut-Off	→+←
	Double Shut-Off	→+←
	Full Flow	→+←

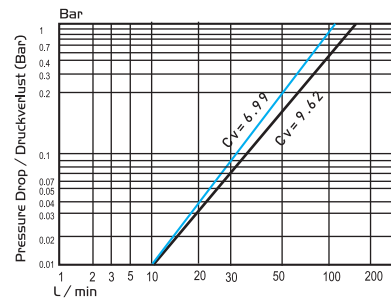

- Double Shut-off / Beidseitig absperrend
- Single Shut-off / Einseitig absperrend

Flow direction - Flußrichtung : Plug to socket - von Stecker zu Kupplung  
Oil Viscosity at - Öl Viskosität 40° : C:13.4 cst

SERIE 101 ■

COUPLINGS, MULTICOUPLINGS & MOULD COOLING PRODUCTS

KUPPLUNGEN, MULTIKUPPLUNGEN & KÜHLUNGSELEMENTE FÜR WERKZEUGE



QUICK COUPLINGS FOR MOULD AND GENERAL INDUSTRY

● **SCHNELLVERSCHLUSSKUPPLUNGEN FÜR FORMWERKZEUGE UND ALLG. INDUSTRIE** ●

Leak-tight during connection Positive Überdeckung

● TST 101.20 TST 101.25

● TST 101.38

**Material - Material**

- Coupler Body - Kupplungsgrundkörper : Brass Nickel Plated - Messing Vernickelt
- Sleeve - Hülse : Stainless Steel - Edelstahl (AISI 420)
- Valve - Ventil : Brass Nickel Plated - Messing Vernickelt
- Springs - Federn : Stainless Steel - Edelstahl
- Balls - Kugeln : Stainless Steel - Edelstahl
- Seals - Dichtungen : Fluorocarbon FPM (V)
- Plug - Nippel : Stainless Steel - Edelstahl (AISI 420)



Ø Nominal - Nennweite (mm)		20	25
Working Pressure - Betriebsdruck (bar)		16	16
Cross section - Querschnitt (mm <sup>2</sup> )		314	314
Number of the Balls - Anzahl der Kugeln		12	12
Working Temperature - Betriebstemperatur	V - Viton (FPM)	-10°C +200°C	-10°C +200°C
	E - Ethylene Prop. (EPDM)	-20°C +150°C	-20°C +150°C
	Ni - Nitrile (NBR)	-15°C +100°C	-15°C +100°C
Flowing - Ausführung	Single Shut-Off	→+←	→+←
	Double Shut-Off	→+←	→+←
	Full Flow	→+←	→+←

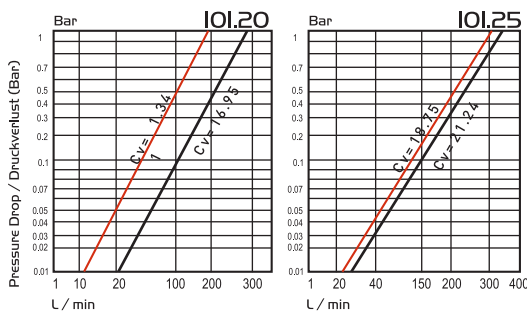

- Double Shut-off / Beidseitig absperrend
- Single Shut-off / Einseitig absperrend

Flow direction - Flußrichtung : Plug to socket - von Stecker zu Kupplung  
Oil Viscosity at - Öl Viskosität 40° : C:13,4 cst

Interchangeability / Kompatibilität: TST Desing

**Material - Material**

- Coupler Body - Kupplungsgrundkörper : Brass Nickel Plated - Messing Vernickelt
- Sleeve - Hülse : Stainless Steel - Edelstahl (AISI 420)
- Valve - Ventil : Brass Nickel Plated - Messing Vernickelt
- Springs - Federn : Stainless Steel - Edelstahl
- Balls - Kugeln : Stainless Steel - Edelstahl
- Seals - Dichtungen : Fluorocarbon FPM (V)
- Plug Body- Nippel : Stainless Steel - Edelstahl (AISI 420)



Ø Nominal - Nennweite (mm)		38
Working Pressure - Betriebsdruck (bar)		16
Cross section - Querschnitt (mm <sup>2</sup> )		1130
Number of the Balls - Anzahl der Kugeln		14
Working Temperature - Betriebstemperatur	V - Viton (FPM)	-10°C +200°C
	E - Ethylene Prop. (EPDM)	-20°C +150°C
	Ni - Nitrile (NBR)	-15°C +100°C
Flowing - Ausführung	Single Shut-Off	→+←
	Double Shut-Off	→+←
	Full Flow	→+←

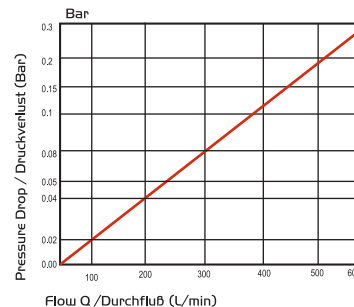

- Double Shut-off / Beidseitig absperrend

Flow direction - Flußrichtung : Plug to socket - von Stecker zu Kupplung  
Oil Viscosity at - Öl Viskosität 38° : 43 cst

**COUPLINGS, MULTICOUPLINGS & MOULD COOLING PRODUCTS**

KUPPLUNGEN, MULTIKUPPLUNGEN & KÜHLUNGSELEMENTE FÜR WERKZEUGE

**SERIE 101**



**Coupler  
Kupplung**

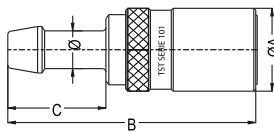

Coupler with hose tail  
Kupplung mit Schlauchtülle

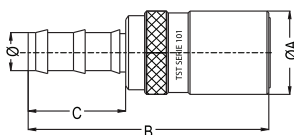

Push lock hose tail coupler  
Kupplung mit Schnellsteck - Schlauchtülle

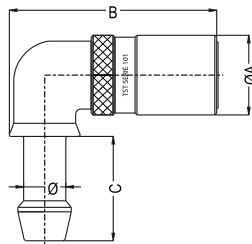

Coupler with hose tail 90°  
Kupplung mit 90° Schlauchtülle

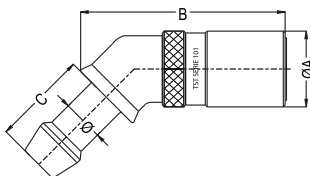

Coupler with hose tail 45°  
Kupplung mit 45° Schlauchtülle

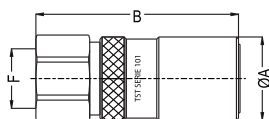

Coupler with female thread  
Kupplung mit Innengewinde

NW Size/ Größe mm	Connection Anschlüsse (F/Ø)	Single & Double Shut-off Einseitig & Beidseitig absperrend	Full Flow Nicht absperrend	ØA	B	C	SW
		Order No / Bestellnr.	Order No / Bestellnr.				
6	08 - 5/16"	101.06 HGB 08	101.06 HGF 08	19	60	23	
9	12 - 15/32"	101.09 HGB 12	101.09 HGF 12	25	69.5	28	
12	13 - 1/2"	101.12 HGB 13	101.12 HGF 13	31	82	28	
12	16 - 5/8"	101.12 HGB 16	101.12 HGF 16	31	82	28	
16	16 - 5/8"	101.16 HGB 16	101.16 HGF 16	32	109	28	
16	19 - 3/4"	101.16 HGB 19	101.16 HGF 19	38	108.5	33	
16	19 - 3/4"		101.16 HGF 19SP	38	88	33	
6	10 - 3/8"	101.06 FGB 10	101.06 FGF 10	19	60	24	
9	10 - 3/8"	101.09 FGB 10	101.09 FGF 10	25	69.5	24	
9	13 - 1/2"	101.09 FGB 13	101.09 FGF 13	25	69.5	28	
12	13 - 1/2"	101.12 FGB 13	101.12 FGF 13	31	92	38	
16	16 - 5/8"	101.16 FGB 16	101.16 FGF 16	32	109	38	
16	19 - 3/4"	101.16 FGB 19	101.16 FGF 19	38	109	38	
6	08 - 5/16"	101.06 HGB 08-90°	101.06 HGF 08-90°	19	59	23	
9	10 - 3/8"	101.09 HGB 10-90°	101.09 HGF 10-90°	25	60	28	
9	12 - 15/32"	101.09 HGB 12-90°	101.09 HGF 12-90°	25	65	28	
12	16 - 5/8"	101.12 HGB 16-90°	101.12 HGF 16-90°	31	82	28	
16	19 - 3/4"	101.16 HGB 19-90°	101.16 HGF 19-90°	38	132	60	
6	08 - 5/16"	101.06 HGB 08-45°	101.06 HGF 08-135°	19	59	23	
6	BSP 1/4"	101.06 DGB 13	101.06 DGF 13	19	46	17	
6	NPT 1/4"	101.06 NGB 13	101.06 NGF 13	19	46	17	
9	BSP 3/8"	101.09 DGB 17	101.09 DGF 17	25	53	22	
9	NPT 1/4"	101.09 NGB 17	101.09 NGF 17	25	51	22	
12	BSP 1/2"	101.12 DGB 21	101.12 DGF 21	31	67	27	
12	NPT 1/2"	101.12 NGB 21	101.12 NGF 21	31	65	27	
16	BSP 3/4"	101.16 DGB 26	101.16 DGF 26	38	90.5	35	
16	BSP 3/4"		101.16 NGF 26SP	38	55	35	
16	NPT 3/4"	101.16 NGB 26	101.16 NGF 26	38	88.5	35	



**COUPLINGS, MULTICOUPLINGS & MOULD COOLING PRODUCTS**

**SERIE 101**

**KUPPLUNGEN, MULTIKUPPLUNGEN & KÜHLUNGSELEMENTE FÜR WERKZEUGE**



**Coupler  
Kupplung**

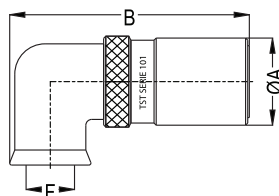

Coupler with female thread 90°  
Kupplung mit 90° Innengewinde

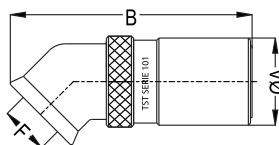

Coupler with female thread 45°  
Kupplung mit 45° Innengewinde

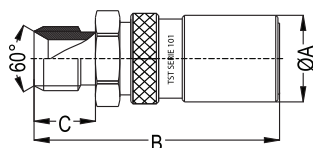

Coupler with male thread  
Kupplung mit Aussengewinde

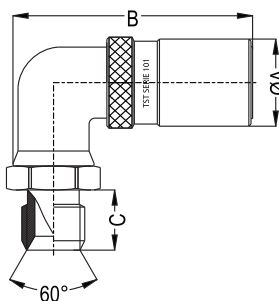

Coupler with male thread 90°  
Kupplung mit 90° Aussengewinde

NW Size/ Größe mm	Connection Anschlüsse (F/Ø)	Single & Double Shut-off Einseitig & Beidseitig absperrend	Full Flow Nicht absperrend	ØA	B	C	SW
		Order No / Bestellnr.	Order No / Bestellnr.				
6	BSP 1/4"	101.06 DGB 13-90°	101.06 DGF 13-90°	19	59		
6	NPT 1/4"	101.06 NGB 13-90°	101.06 NGF 13-90°	19	59		
9	BSP 3/8"	101.09 DGB 17-90°	101.09 DGF 17-90°	25	65		
9	NPT 3/8"	101.09 NGB 17-90°	101.09 NGF 17-90°	25	65		
12	BSP 1/2"	101.12 DGB 21-90°	101.12 DGF 21-90°	31	82		
12	NPT 1/2"	101.12 NGB 21-90°	101.12 NGF 21-90°	31	82		
6	BSP 1/4"	101.06 DGB 13-45°	101.06 DGF 13-135°	19	59		
6	BSP 1/4"	101.06 EGB 13	101.06 EGF 13	19	55	17	
9	BSP 3/8"	101.09 EGB 17	101.09 EGF 17	25	61	22	
12	BSP 1/2"	101.12 EGB 21	101.12 EGF 21	31	72	27	
16	BSP 3/4"	101.16 EGB 26	101.16 EGF 26	38	115.5	32	
6	BSP 1/4"	101.06 EGB 13-90°	101.06 EGF 13-90°	19	55	17	
9	BSP 3/8"	101.09 EGB 17-90°	101.09 EGF 17-90°	25	61	22	
12	BSP 1/2"	101.12 EGB 21-90°	101.12 EGF 21-90°	31	72	27	
16	BSP 3/4"	101.16 EGB 26-90°	101.16 EGF 26-90°	38	115.5	32	

**COUPLINGS, MULTICOUPLINGS & MOULD COOLING PRODUCTS**

KUPPLUNGEN, MULTIKUPPLUNGEN & KÜHLUNGSELEMENTE FÜR WERKZEUGE

**SERIE 101**



**Plug / Nippel**

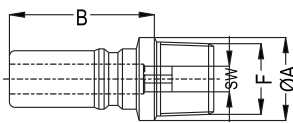

Tapered Male Threaded Plugs  
Nippel mit konischem Aussengewinde

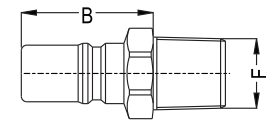

Tapered Male Threaded Plugs  
Nippel mit konischem Aussengewinde

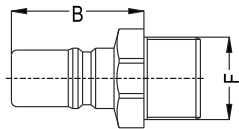

Male Threaded Plugs  
Nippel mit zylindrischem Aussengewinde

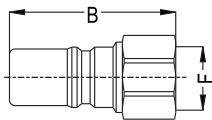

Female Threaded Plugs  
Nippel mit Innengewinde

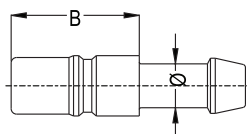

Hose tail plug  
Nippel mit Schlauchtülle

NW Size/ Größe mm	Connection Anschlüsse (F/Ø)	Order No / Bestellnr.	B	ØD	SW
6	BSPT 1/8"	101.06 RU 10	21	10	5
6	BSPT 1/4"	101.06 RU 13	22	11	5
6	NPT 1/8"	101.06 TU 10	22	14	5
6	NPT 1/4"	101.06 TU 13	22	14	5
9	BSPT 1/4"	101.09 RU 13	21	14	8
9	BSPT 3/8"	101.09 RU 17	21	14	8
9	NPT 1/4"	101.09 TU 13	23	17	8
9	NPT 3/8"	101.09 TU 17	23	17	8
12	BSPT 3/8"	101.12 RU 17	26	18	10
12	BSPT 1/2"	101.12 RU 21	51.5		24
12	NPT 3/8"	101.12 TU 17	28		22
12	NPT 1/2"	101.12 TU 21	38		22
16	BSPT 1/2"	101.16 RU 21	39		24
16	BSPT 3/4"	101.16 RU 26	41.5		27
9	BSP 1/2"	101.09 EU 21	25		22
12	BSP 3/4"	101.12 EU 26	30		27
16	BSP 1"	101.16 EU 33	38		32
16	M24x1.5	101.16 EUM 24	41.5		27
6	BSP 1/4"	101.06 DU 13	34		17
6	NPT 1/4"	101.06 NU 13	47		17
9	BSP 3/8"	101.09 DU 17	37		22
9	NPT 3/8"	101.09 NU 17	49		22
12	BSP 1/2"	101.12 DU 21	45		27
12	NPT 1/2"	101.12 NU 21	67		27
16	BSP 3/4"	101.16 DU 26	58		32
16	NPT 3/4"	101.16 NU 26	80		32
6	Ø8 5/16"	101.06 HU 08	24.5		
9	Ø12 15/32"	101.09 HU 12	25.5		
12	Ø16 5/8"	101.12 HU 16	30		
16	Ø19 3/4"	101.16 HU 19	37		



**COUPLINGS, MULTICOUPLINGS & MOULD COOLING PRODUCTS**

**KUPPLUNGEN, MULTIKUPPLUNGEN & KÜHLUNGSELEMENTE FÜR WERKZEUGE**

SERIE 101



**Shut-off Plugs**  
Verschlussnippel

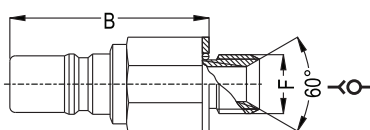

Male Threaded Shut-off Plugs with parallel tread  
Verschlussnippel mit zylindrischem Aussengewinde

NW Size/ Größe mm	Connection Anschlüsse (F/Ø)	Order No / Bestellnr.	B	ØD	SW
6	BSP 1/8"	101.06 OUB 10	38		17
6	BSP 1/4"	101.06 OUB 13	36		17
9	BSP 1/4"	101.09 OUB 13	38		19
9	BSP 3/8"	101.09 OUB 17	38		20
12	BSP 3/8"	101.12 OUB 17	53.5		24
12	BSP 1/2"	101.12 OUB 21	50		24
16	BSP 3/4"	101.16 OUB 26	67		32

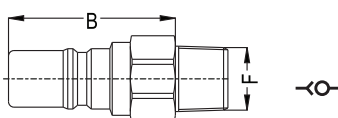

Tapered Male Shut-off Threaded Plugs  
Verschlussnippel mit konischem Aussengewinde

6	BSPT 1/8"	101.06 RUB 10	36		17
6	BSPT 1/4"	101.06 RUB 13	33		17
6	NPT 1/8"	101.06 TUB 10	36		17
6	NPT 1/4"	101.06 TUB 13	33		17
9	BSPT 1/4"	101.09 RUB 13	39		19
9	BSPT 3/8"	101.09 RUB 17	39.5		19
9	NPT 1/4"	101.09 TUB 13	39		19
9	NPT 3/8"	101.09 TUB 17	35.5		19
12	BSPT 3/8"	101.12 RUB 17	51.5		24
12	BSPT 1/2"	101.12 RUB 21	46		24
12	NPT 3/8"	101.12 TUB 17	51.5		24
12	NPT 1/2"	101.12 TUB 21	46		24
16	BSPT 3/4"	101.16 RUB 26	62		32
16	NPT 3/4"	101.16 TUB 26	62		32

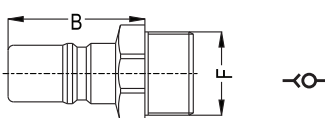

BSP Male Threaded Shut-off Plugs  
Verschlussnippel mit zylindrischem Aussengewinde

6	BSP 3/8"	101.06 EUB 17	26		19
9	BSP 1/2"	101.09 EUB 21	25		22
12	BSP 3/4"	101.12 EUB 26	30		27
16	BSP 1"	101.16 EUB 33	38		32

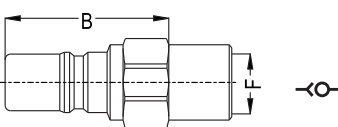

Female Threaded Shut-off Plugs  
Verschlussnippel mit Innengewinde

6	BSP 1/4"	101.06 DUB 13	47		17
6	NPT 1/4"	101.06 NUB 13	47		17
9	BSP 1/4"	101.09 DUB 13	48.5		19
9	NPT 1/4"	101.09 NUB 13	48.5		19
9	BSP 3/8"	101.09 DUB 17	49		22
12	NPT 1/2"	101.12 NUB 21	85		27
16	BSP 3/4"	101.16 DUB 26	81		32
16	NPT 3/4"	101.16 NUB 26	81		32

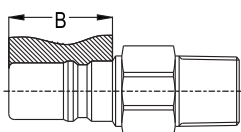

Connecting Size  
Anschlussabmessungen

6		101.06	17.5		
9		101.09	18.5		
12		101.12	23		
16		101.16	30		



**COUPLINGS, MULTICOUPLINGS & MOULD COOLING PRODUCTS**  
KUPPLUNGEN, MULTIKUPPLUNGEN & KÜHLUNGSELEMENTE FÜR WERKZEUGE

**SERIE 101**



Assembling of straight - through plugs on the mould Einbaumaße für Nippel (ohne Ventil) in Werkzeuge

Tapered Male Threaded Plugs  
Nippel mit konischem Aussengewinde

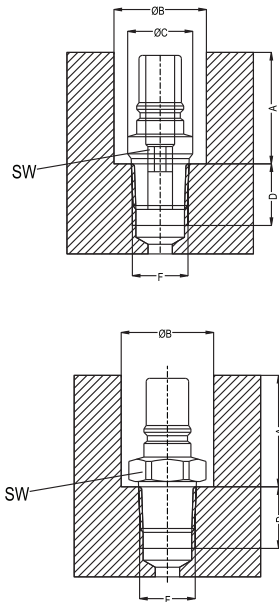

NW Size/ Größe mm	Connection Anschlüsse (F/Ø)	Order No / Bestellnr.	B	ØB	ØC	D	SW
6	BSPT 1/8"	101.06 RU 10	26	20	10	9	5
6	NPT 1/8"	101.06 TU 10	28	20	11	9	5
6	BSPT 1/4"	101.06 RU 13	27	20	14	12	5
6	NPT 1/4"	101.06 TU 13	27	20	14	13	5
9	BSPT 1/4"	101.09 RU 13	26	26	14	12	8
9	NPT 1/4"	101.09 TU 13	26	26	14	13	8
9	BSPT 3/8"	101.09 RU 17	28	26	17	13	8
9	NPT 3/8"	101.09 TU 17	28	26	17	13	8
12	BSPT 3/8"	101.12 RU 17	31	33	18	13	10
12	NPT 3/8"	101.12 TU 17	55	36		11	24
12	BSPT 1/2"	101.12 RU 21	34	33		15	22
12	NPT 1/2"	101.12 TU 21	34	33		15	22
16	BSPT 3/4"	101.16 RU 26	50	40		19	27

Assembling of self-sealing plugs on the mould Einbaumaße für Verschlussnippel in Werkzeuge

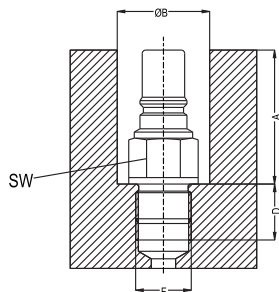

Shut-off Plug with cylindrical male thread  
Verschlussnippel mit zylindrischem Aussengewinde

6	BSP 1/8"	101.06 EUB 10	41	26		9	17
6	BSP 1/4"	101.06 EUB 13	38	26		12	17
9	BSP 1/4"	101.09 EUB 13	44	29		12	19
9	BSP 3/8"	101.09 EUB 17	40	30		13	20
12	BSP 3/8"	101.12 EUB 17	56	36		13	24
12	BSP 1/2"	101.12 EUB 21	52	36		15	24
16	BSP 3/4"	101.16 EUB 26	70	46		16	32

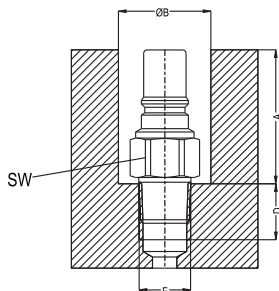

Shut-off Plug with conical male thread  
Verschlussnippel mit konischem Aussengewinde

6	BSPT 1/8"	101.06 RUB 10	42	26		9	17
6	NPT 1/8"	101.06 TUB 10	42	26	9	17	
6	BSPT 1/4"	101.06 RUB 13	38	26		13	17
6	NPT 1/4"	101.06 TUB 13	38	26	13	17	
9	BSPT 1/4"	101.09 RUB 13	44	29		13	19
9	NPT 1/4"	101.09 TUB 13	44	29	13	19	
9	BSPT 3/8"	101.09 RUB 17	40	29		13	19
9	NPT 3/8"	101.09 TUB 17	40	29	13	19	
12	BSPT 3/8"	101.12 RUB 17	56	36		13	24
12	NPT 3/8"	101.12 TUB 17	56	36	13	24	
12	BSPT 1/2"	101.12 RUB 21	52	36		15	24
12	NPT 1/2"	101.12 TUB 21	52	36	15	24	
16	BSPT 3/4"	101.16 RUB 26	70	46		16	32
16	NPT 3/4"	101.16 TUB 26	70	46	16	32	



**COUPLINGS, MULTICOUPLINGS & MOULD COOLING PRODUCTS**

**SERIE 101** ■

**KUPPLUNGEN, MULTIKUPPLUNGEN & KUHLUNGSELEMENTE FÜR WERKZEUGE**



**Standard version - Standardversion**  
 Viton O-Ring (FPM)  
 Double Shut-off - beideseitig absperrend

**Options - Optionen**  
 E - EPDM Seal - EPDM Dichtung  
 F - Through Flow - freier Durchfluß

For optional orders please add the symbol of your option end of the order no. Bei Bestellungen Kennbuchstabe bitte hinzufügen (Beispiel: 101.20 EG 33 E-F)

**Material - Material**

- Coupler Body - Kupplungsgrundkörper  
 : Brass - Messing  
 Sleeve - Hülse : Stainless Steel - Edelstahl  
 Valve - Ventil : Brass - Messing  
 Springs - Federn : Stainless Steel - Edelstahl  
 Balls - Kugeln : Stainless Steel - Edelstahl  
 Seals - Dichtungen : Viton (V)  
 Plug - Nippel : Stainless Steel - Edelstahl

**Coupler and Plug  
 Kupplung und Nippel**

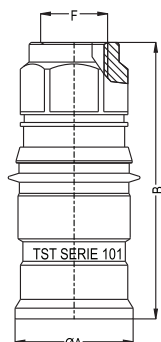

Shut-off Coupler With Female Thread  
 Kupplung mit Innengewinde und Ventil

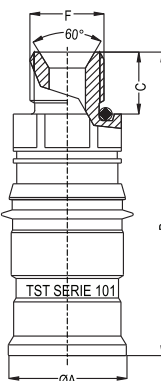

Shut-off Coupler With Male Parallel Thread  
 Kupplung mit zylindrischem Aussengewinde und Ventil

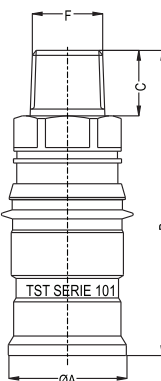

NPT Male Threaded Shut-off Coupler  
 Kupplung mit NPT Aussengewinde und Ventil

Size Nennweite mm	Connection Anschlüsse (F/Ø)	Order No Bestellnr.	ØA	B	C	SW
20	BSP 3/4"	101.20 DGB 26	53	119.5		42
20	NPT 3/4"	101.20 NGB 26	53	119.5		42
20	BSP 1"	101.20 DGB 33	53	119.5		42
20	NPT 1"	101.20 NGB 33	53	119.5		42
25	BSP 1"	101.25 DGB 33	60	140		50
25	BSP 1"1/4	101.25 DGB 42	60	140		50
38	BSP 1"1/2	101.38 DGB 48	82	158		70
38	BSP 2"	101.38 DGB 60	82	158		70

20	BSP 1"	101.20 EGB 33	53	132	20	42
25	BSP 1"	101.25 EGB 33	60	144	20	50
25	BSP 1"1/4	101.25 EGB 42	60	144	21	50
38	BSP 1"1/2	101.38 EGB 48	82	167	24	70

20	NPT 1"	101.20 TGB 33	53	132	20	42
25	NPT 1"	101.25 TGB 33	60	144	20	50
25	NPT 1"1/4	101.25 TGB 42	60	148.5	24.5	50
38	NPT 1"1/2	101.38 TGB 48	82	167	24.5	70
38	NPT 2"	101.38 TGB 60	82	167	24.5	70

**COUPLINGS, MULTICOUPLINGS & MOULD COOLING PRODUCTS**

KUPPLUNGEN, MULTIKUPPLUNGEN & KUHLUNGSELEMENTE FÜR WERKZEUGE

**SERIE 101**



**Coupler and Plug  
Kupplung und Nippel**

Size Nennweite mm	Connection Anschlüsse (F/Ø)	Order No Bestellnr.	ØA	B	C	SW
-------------------------	-----------------------------------	------------------------	----	---	---	----

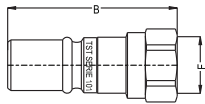

Plug With Female Thread  
Nippel mit Innengewinde

20	BSP 1"	101.20 DU 33		92		41
25	BSP 1"	101.25 DU 33		100		41
38	BSP 1"1/2	101.38 DU 48		110		65

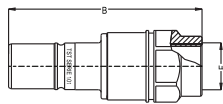

Shut-off Plug With  
Female Thread  
Verschlussnippel mit  
Innengewinde

20	BSP 3/4"	101.20 DUB 26		126.5		42
20	BSP 1"	101.20 DUB 33		126.5		42
20	NPT 1"	101.20 NUB 33		126.5		42
25	BSP 1"	101.25 DUB 33		148.5		50
25	BSP 1"1/4	101.25 DUB 42		158		50
38	BSP 1"1/2	101.38 DUB 48		156		70
38	BSP 2"	101.38 DUB 60		156		70

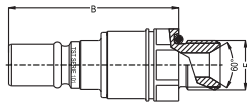

Shut-off Plug With  
Male Parallel Thread  
Verschlussnippel mit  
zylindrischem  
Aussengewinde

20	BSP 1"	101.20 EUB 33		120		42
25	BSP 1"	101.25 EUB 33		127		50
25	BSP 1"1/4	101.25 EUB 42		131.5		50
38	BSP 1"1/2	101.38 EUB 48		156		70
38	BSP 2"	101.38 EUB 60		161		70

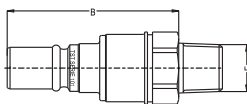

NPT Male Threaded  
Shut-off Plug  
Verschlussnippel mit  
NPT Aussengewinde

20	NPT 1"	101.20 TUB 33		120		42
25	NPT 1"	101.25 TUB 33		127		50
25	NPT 1"1/4	101.25 TUB 42		131.5		50
38	NPT 1"1/2	101.38 TUB 48		156		70
38	NPT 2"	101.38 TUB 60		161		70

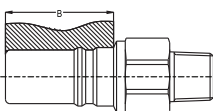

Connecting Size  
Anschlussabmessungen

20		101.20		60		
25		101.25		72.5		
38		101.38		75		

**Standard version - Standardversion**  
Viton O-Ring (FPM)  
Double Shut-off - beideseitig absperrend

**Options - Optionen**

E - EPDM Seal - EPDM Dichtung  
F - Through Flow - freier Durchfluß

For optional orders please add the symbol of your option end of the order no.  
Bei Bestellungen Kennbuchstabe bitte hinzufügen  
(Beispiel: 101.20 EG 33 E-F)

**Material - Material**

Coupler Body -  
Kupplungsgrundkörper

: Brass - Messing  
Sleeve - Hülse : Stainless Steel - Edelstahl  
Valve - Ventil : Brass - Messing  
Springs - Federn : Stainless Steel - Edelstahl  
Balls - Kugeln : Stainless Steel - Edelstahl  
Seals - Dichtungen : Viton (V)  
Plug - Nippel : Stainless Steel - Edelstahl

SERIE 101 ■

**COUPLINGS, MULTICOUPLINGS & MOULD COOLING PRODUCTS**

KUPPLUNGEN, MULTIKUPPLUNGEN & KÜHLUNGSELEMENTE FÜR WERKZEUGE

**MULTI COUPLINGS MULTIKUPPLUNGSSYSTEME**

TST Multi coupling systems are applicable for quick changing of injection moulding and die cast equipments. This system avoids from the wrong connections in a quick and simple way.

tst Multi Coupling connection is starting from 3 circuits and it may increase up to 12 circuits + according to customer needs. Water Couplers for max 10 bar and 180 °C and also there exist manual multi couplers for electrical and hydraulic connections in our product range.

**TST Standard Multi Coupling Ranges**

- M106 (Flow Size : 6 mm)
- M109 (Flow Size : 9 mm)
- M112 (Flow Size : 12 mm)
- M116 (Flow Size : 16 mm)

**According to the requested coupler quantity:**

- 6 couplers : 3 circuits
- 8 couplers : 4 circuits
- 10 couplers : 5 circuits
- 12 couplers : 6 circuits
- 16 couplers : 8 circuits
- 20 couplers : 10 circuits
- 24 couplers : 12 circuits

tst Multikupplungssysteme werden zur Verkürzung der Werkzeugwechselzeit im Spritzguss und Druckguss eingesetzt. Diese Systeme verhindern zusätzlich ein Verwechseln der einzelnen Kreisläufe untereinander.

tst Multikupplungssysteme gibt es ab 3 bis über 12 Kreisläufe je nach Kundenanforderung.

Wasserkupplungen sind ausgelegt für maximal 10bar und 180C° und es gibt ebenso manuell zu betätigende Multikupplungen für Elektrik und Hydraulik in unserem Produktportfolio.

**tst Standard Multikupplungsserien**

- M106 (NW : 6 mm)
- M109 (NW : 9 mm)
- M112 (NW : 12 mm)
- M116 (NW : 16 mm)

**Entsprechend der angeforderten Kupplungsmenge :**

- 6 Kupplungen : 3 Kreisläufe
- 8 Kupplungen : 4 Kreisläufe
- 10 Kupplungen : 5 Kreisläufe
- 12 Kupplungen : 6 Kreisläufe
- 16 Kupplungen : 8 Kreisläufe
- 20 Kupplungen : 10 Kreisläufe
- 24 Kupplungen : 12 Kreisläufe

